

GO



GRAND | HYATT

GRAND

MEETINGS & EVENT PRESENTATION

GRAND | HYATT®



NEW DEVELOPMENT

TOTAL OF 549 ROOMS

MEETING & EVENT SPACE up to 4.000 m² (43.055,64 sq ft.)

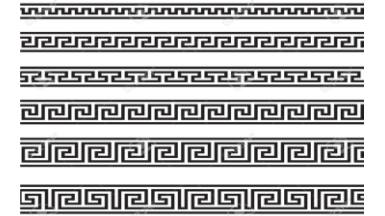
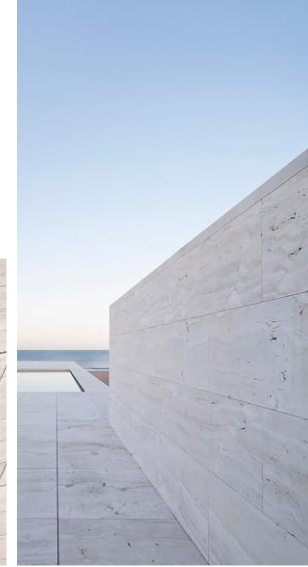

SCHEMATIC DESIGN

The building will be clad with a light warm natural stone similar to travertine.

The inner courtyard facades are designed based on the same concept as the main façade, but without the angled balconies and also slightly smaller. They are also accessible by sliding doors.

Glass has been chosen for the railings for various practical reasons alongside the aesthetic considerations. Glass will provide additional sound protection from the busy traffic into the hotel rooms and provides an added safety element protecting against items falling from the balconies.

GRAND | HYATT

GRAND | HYATT





Foyer area outside of CARYATIDS
Grand Ballroom



Grand Ballroom – CARYATIDS
I, II, III, IV, V, VI



**OUTDOOR PATIO AREA OUTSIDE of Caryatids
Main Ballroom**



GRAND PATIO

**OUTDOOR PATIO AREA OUTSIDE of
Caryatids Main Ballroom**

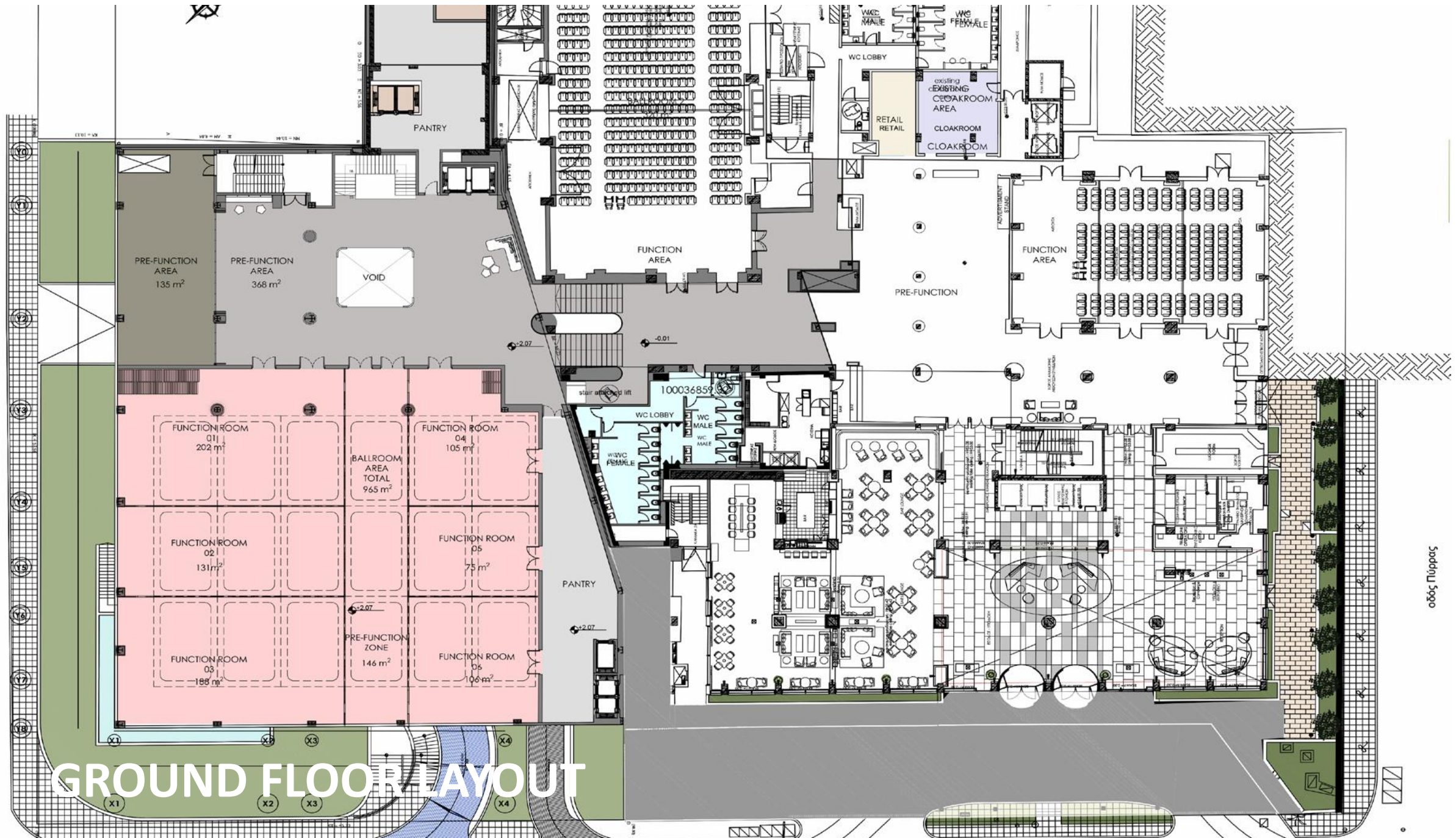

GROUND FLOOR LAYOUT



IRIS SYNDICATE ROOM

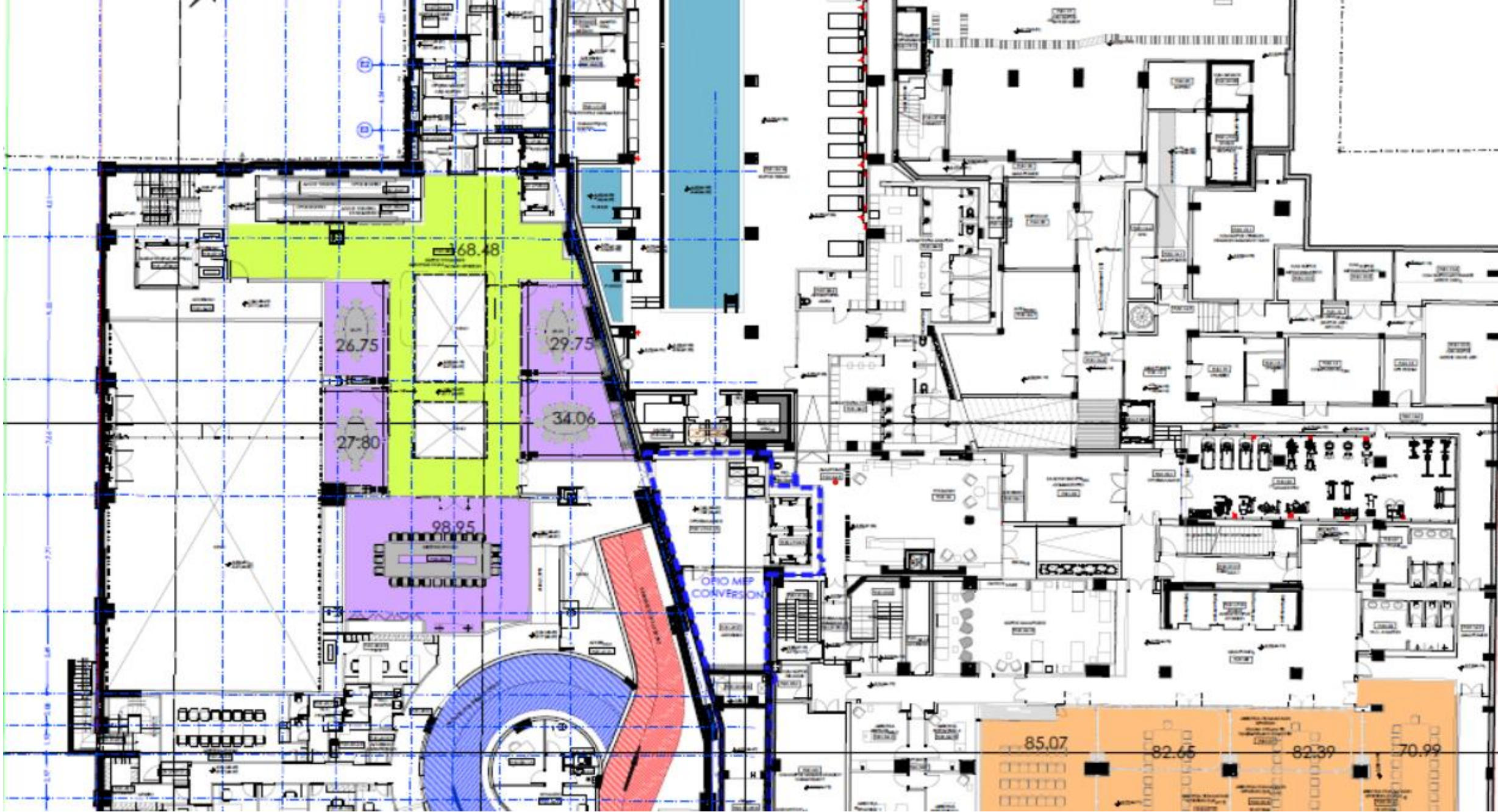

MEETING / EVENT SPACE- Lower Ground -1



FOYER EVENT AREA outside ARISTOTLE
Lower Ground Floor -2



ARISTOTLE I & II

Lower Ground Floor -2

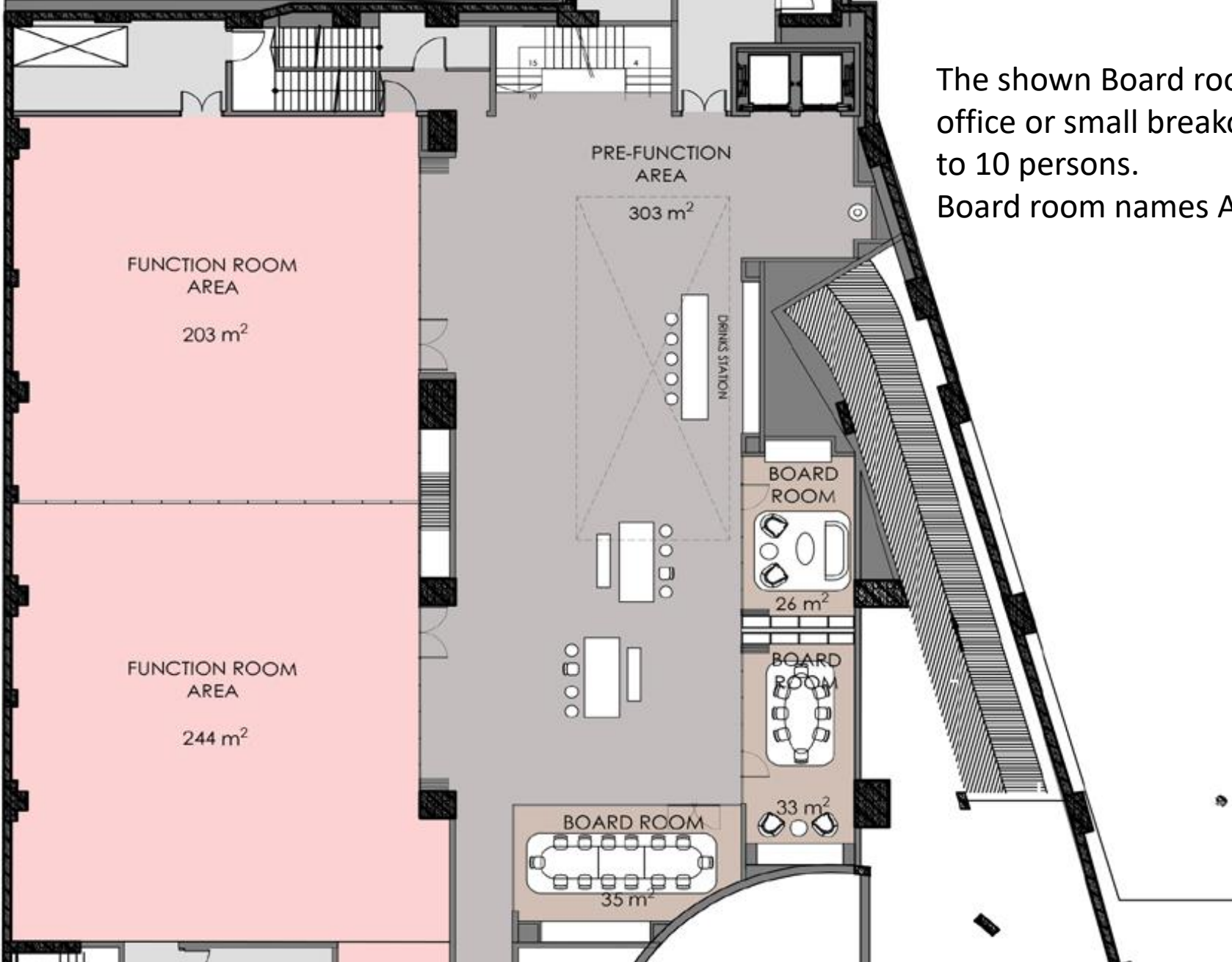

The shown Board rooms are suggested as office or small breakout rooms seating up to 10 persons.

Board room names Artemis, Apollo, Arion

FLOOR PLAN ARISTOTLE

Lower Ground Floor -2



PARTHENON I & II



EVENT AREA PARTHENON FOYER



EVENT AREA PARTHENON FOYER



EVENT AREA CYCLADES FOYER



CYCLADES I, II, III



CYCLADES I & II



CYCLADES III



ESTIA or ULYSSES



METIS I- II- III- IV





Penthouse Living area visual
with private pool



**GRAND BY INTERNI
ROOFTOP RESTAURANT**



**GRAND BY INTERNI
ROOFTOP RESTAURANT**

An aerial photograph of a modern outdoor atrium pool. The pool is rectangular and filled with clear blue water, featuring a mosaic tile pattern on the bottom. It is surrounded by a light-colored stone or concrete deck. Along the top and bottom edges of the pool, there are rows of white lounge chairs. A central island in the pool contains several large green plants, including palm trees. To the right of the pool, there is a seating area with white sofas and chairs on a green lawn. The overall design is clean and minimalist.

**OUTDOOR ATRIUM
POOL**



**ROOFTOP INFINITY
POOL**



GRAND | HYATT



ROOFTOP DISPLAY

GO

[THANK YOU]

GRAND

GRAND | HYATT®